



6 Osborne Court Leeming, WA

4 2 2

UNDER OFFER

MASSIVE BLOCK & HUGE HOME! If you've looked at the photos and thought "this is a good one!" you'd be right....in fact it's "a very good one!"

Incredible and extremely rare landholding of 846 sqm and an IMPRESSIVELY LARGE home, perfect for growing or grown up family.

MAJESTICALLY perched at the top of this small, elevated cul de sac, there are features on offer that will leave you in no doubt, this is a home many others buyers will want to secure.

Making maximum use of not only the lot size, but also the land shape, the final product culminates in a wonderful home & amazing outdoor setting.

From here you can overlook the meals, family room and outdoor entertaining area. The remaining 3 bedrooms are all Queensize, with built in robes and hybrid timber flooring, while the main bathroom and a spacious laundry have both been beautifully refurbished to

UNDER OFFER

Type : House
Land : 846 m2
Building Size : 235 m2

Council Rates : \$2,469.37/year (approx)

Water Rates : \$1,618.74/year (approx)

Brian Devereux

0418 959 219

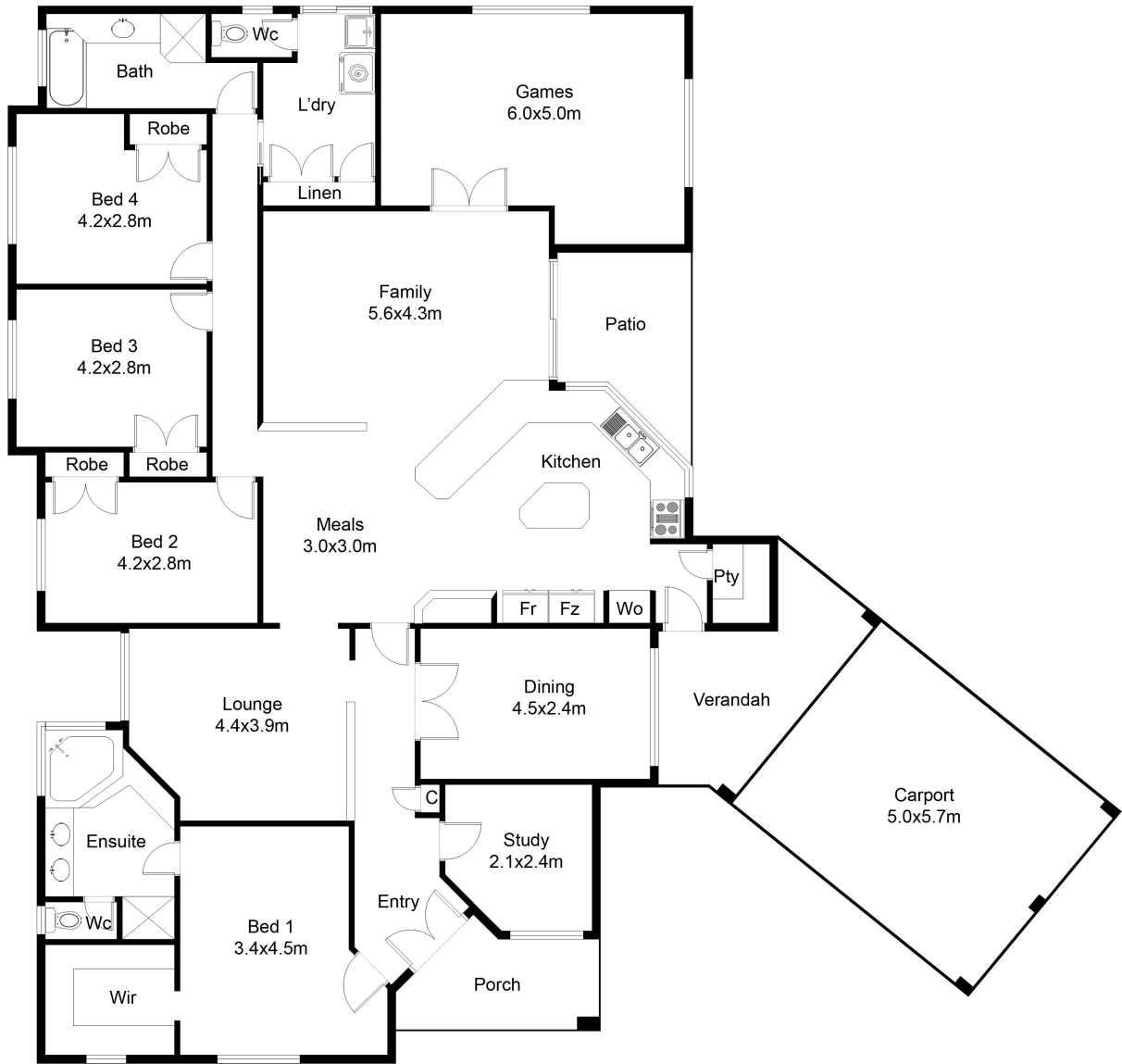

FLOOR PLAN

This floor plan including furniture, fixture measurements and dimensions are approximate and for illustrative purposes only. BoxBrownie.com gives no guarantee, warranty or representation as to the accuracy and layout. All enquiries must be directed to the agent, vendor or party representing this floor plan.

6 Osborne Court Leeming